

Item description/product images



Description

Material:

Clamp connector thermoplastic.
Flange aluminium.

Version:

Clamp connector black.
Flange bright.

Note:

Vibration-resistant, lockable monitor bracket with angle adjustment in 15° increments. Universal mounting plate with a swivel range of 60°. For dynamic loads of up to 3 kg and static loads of up to 10 kg. Universal mounting holes enable easy mounting on panel elements.

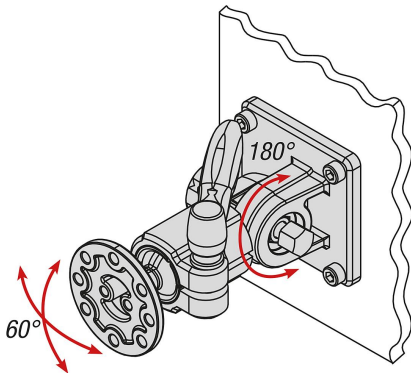

Drawings

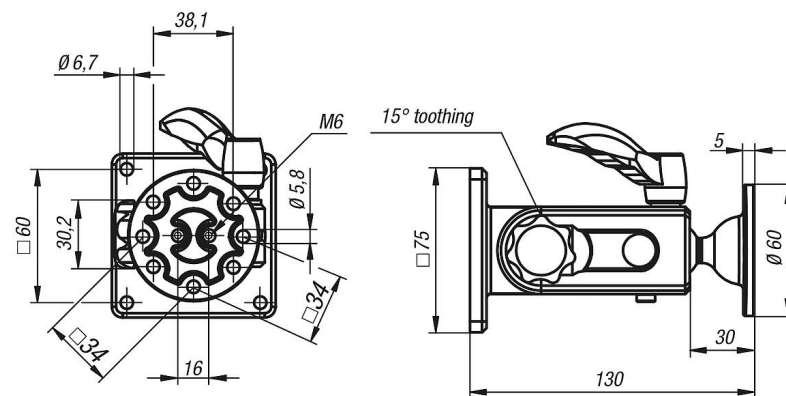

Overview of items

Order No.	Image	Version 1
29180-3005		Bracket

