

## Item description/product images



## Description

**Material:**

Clamp connector thermoplastic.  
Flange aluminium.

**Version:**

Clamp connector black.  
Flange bright.

**Note:**

Two universal mounting plates with a swivel range of 60°. For dynamic loads up to 3 kg and static loads up to 10 kg.  
Universal mounting holes enable easy mounting on panel elements.

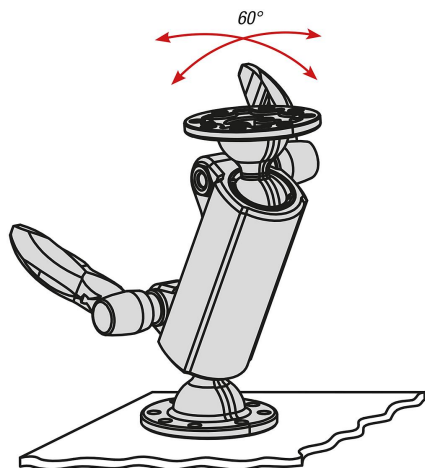

## Drawings

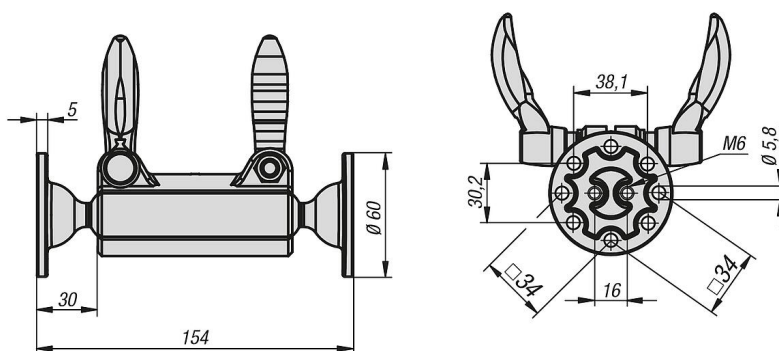

## Overview of items

Order No.	Image	Version 1
29180-3006		double

