

## Item description/product images



## Description

**Material:**

Sleeve steel.  
Spring stainless steel 1.4310.  
Ball steel or POM.

**Version:**

Sleeve black oxidised.  
Ball hardened, bright.

## Drawings

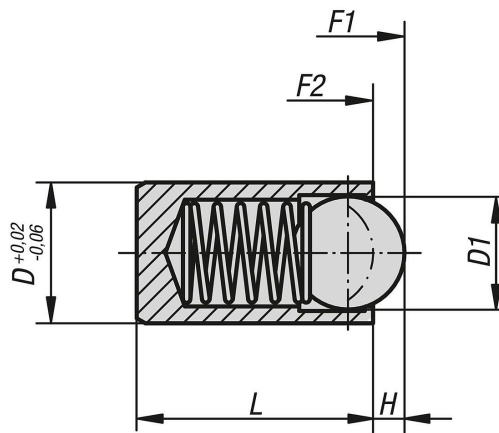

## Overview of items

## Spring plungers, smooth version, without collar, steel

Order No.	Component material	D	D1	H=Stroke	L	Spring force initial pressure F1 approx. N	Spring force final pressure F2 approx. N
03071-90-103	steel	3	2	0,65	7	5	7
03071-90-104	steel	4	3	0,8	9	12	22
03071-90-105	steel	5	4	1	12	19	30
03071-90-106	steel	6	5	1,5	14	22	40
03071-90-108	steel	8	6	1,8	16	42	73
03071-90-110	steel	10	8	2,7	22	54	100
03071-90-112	steel	12	10	3,2	24	54	122
03071-90-304	POM	4	3	0,6	9	12	22
03071-90-305	POM	5	4	0,9	12	19	30
03071-90-306	POM	6	5	1,3	14	22	40
03071-90-308	POM	8	6	1,7	16	42	73
03071-90-310	POM	10	8	2,6	22	54	100
03071-90-312	POM	12	10	3,1	24	54	122