

## Item description/product images

**Description****Material:**

Cam screw QT steel.

Hexagon brass.

Clamping lever high-performance thermoplastic, fibreglass reinforced.

**Version:**

Cam screw black oxidised.

Clamping lever black grey RAL 7021.

**Note:**

Cam screws with clamping levers can be used in a variety of ways for tool-free clamping. The the integrated clamping lever enables many elements to be rapidly clamped. The brass clamp nut offers a gentle yet extremely stable and secure clamping of workpieces. Even entire subplates can be equipped by using several cam screws with clamping lever.

Clockwise rotation is recommended for clamping. The marking on the cam screw should be on the right after clamping. (Screw in the cam screw as far as it will go, then turn it back one turn).

"S" = Distance from the workpiece to the screw centre (clamping screw).

**Assembly:**

Clamping process:

1. Screw in the cam screw as far as it will go.
2. Screw the cam screw back one turn.
3. Position the workpiece.
4. Turn the cam screw clockwise to clamp the workpiece. (The marking on the cam screw should be on the right after clamping).

## Drawings

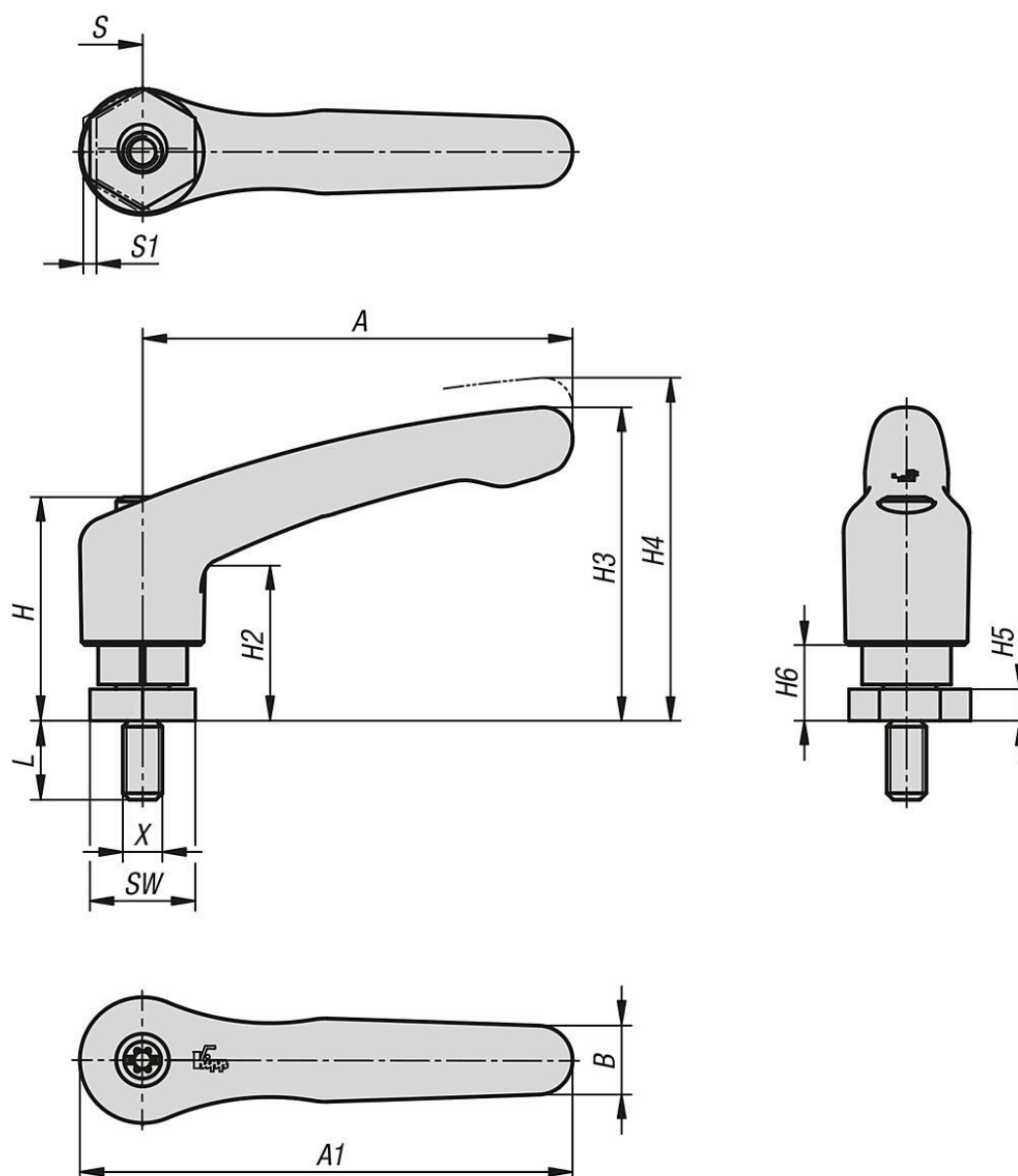

## Overview of items

## Cam screws with clamping lever

Order No.	X	L	A	A1	B	H	H2	H3	H4	H5	H6	S	SW	S1 (travel)	Clamping force kN	Tightening torque max. Nm
04435-10-06	M6	12	65,2	74,8	10,5	34	23,6	47,6	52,1	4,8	11,5	7,8	16	1,01	1,2	8,4
04435-10-08	M8	15	80,2	91,1	11,5	43,2	29,7	60,2	65,4	4,8	16,2	10,2	20,6	1,01	1,5	13,7
04435-10-10	M10	20	80,2	91,1	11,5	44,1	30,5	60,2	65,4	6,4	17,1	10,2	20,6	1,27	1,5	13,7
04435-10-12	M12	25	96,8	110,3	14,1	53	37,6	72,3	78	9,5	20	12,7	25,4	2,03	1,7	15
04435-10-16	M16	30	110,9	126,6	15,1	62,3	44,5	86,1	92,4	12,7	25,2	15	30,2	2,54	2,8	17,1

