

## Item description/product images

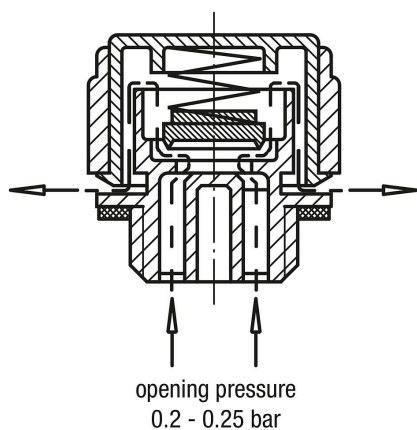

Operating principle



## Description

**Material:**

Housing and cap thermoplastic polyamide 66.  
Spring stainless steel.  
Lift disc and flat seal rubber (NBR).

**Version:**

Housing black.  
Cap red.

**Note:**

Opening pressure 0.20 – 0.25 bar.

**Temperature range:**

Temperature resistant with oil up to 100°C.

**Drawing reference:**

- 1) flat seal
- 2) lift disc
- 3) cap

## Drawings

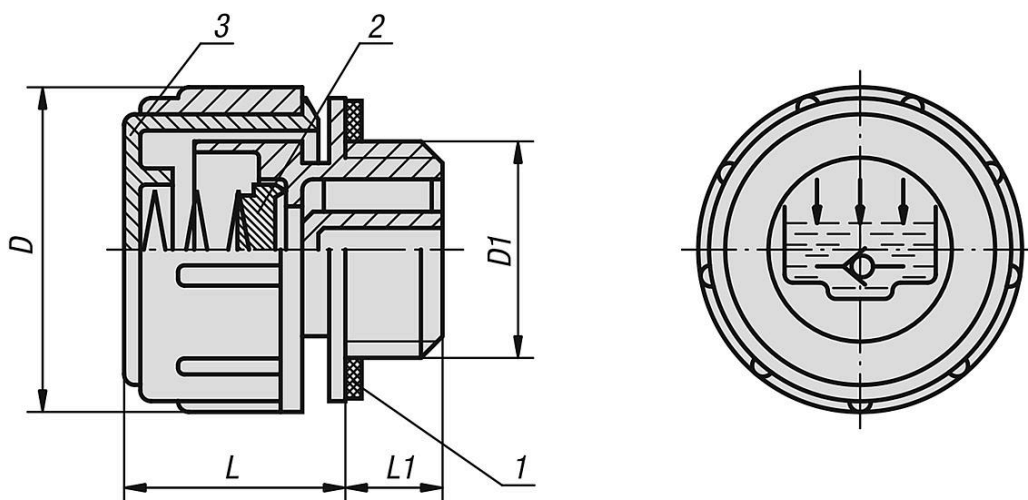

## Overview of items

Order No.	D	D1	L	L1
28038-30014	30	G1/4	21	10
28038-30038	30	G3/8	21	10
28038-30012	30	G1/2	21	10

